

# Selangor's New Sustainable Integrated Lifestyle Hub

Commercial | Medical | Retail | Dining | Sports

ANCUBIC  
HARMONI CITY

# The Advantage Of A Central Location

Ancubic Harmoni offers a prime location as a commercial hub with the advantage of established highways.

- 150 m to Village Grocer (in Ancubic Harmoni)
  - 3 km to malls
  - 5 km to Tenby International School
  - 6 km to Kota Kemuning
- 10 km to Bukit Kemuning Golf & Country Resort
  - 15 km to Puchong
  - 25 km to Sultan Abdul Aziz Shah Airport
  - 35 km to KLIA 1 & 2



SALES GALLERY  
Persiaran Arman Perdana 3,  
Tropicana Arman, 41200 Telok  
Panglima Garang, Selangor.

HEADQUARTER  
G-01, Residential Rimba Pantarl Dalem,  
No.6, Jalan Pantarl Sentral 3,  
Pantarl Dalem, 68200 Kuala Lumpur.

FOR MORE INFORMATION, PLEASE CONTACT:  
012-786 1501  
012-368 1503

All information contained herein (including specifications, plans, measurements and illustration) are subject to amendments, variations and modifications without notification as may be required by the relevant authorities or developer's consultants and is not intended to form and cannot form part of an offer and contract. Whilst every reasonable care has been taken in preparing this information, the developer cannot be held liable for any variation or inaccuracy. The proposal and recommendations contained hereunder remain the sole property of Ancubic Valley Sdn. Bhd. Any unauthorised duplication or content use without consent from authority from Ancubic Valley Sdn. Bhd. is deemed as breach of copyright. © All copyright reserved.

# Spaces Designed For Business Success

Harmoni 1 – the heart of Ancubic Harmoni that will drive commercial excellence and business opportunities.



3½ & 4-storey shop offices with lifts



Shared & individual lifts with direct access to basement car park



1.5km circular pet-friendly Botanical Park walkpath



Retail kiosks



24-hour security



Shops fronting main road



Artist's impression

# Redefining Commercial Lifestyle



Artist's impression

## Site Plan

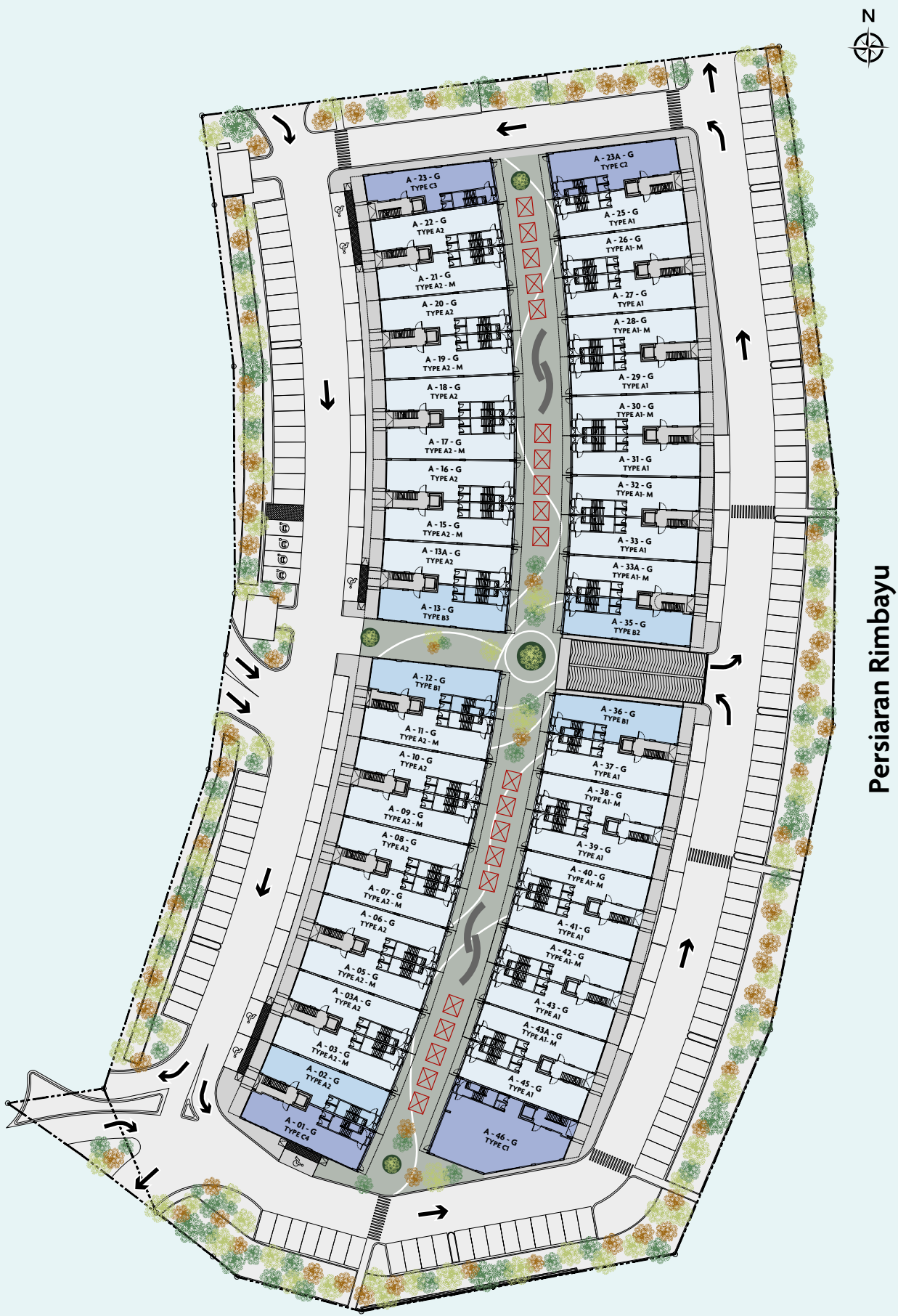

## Floor Plans

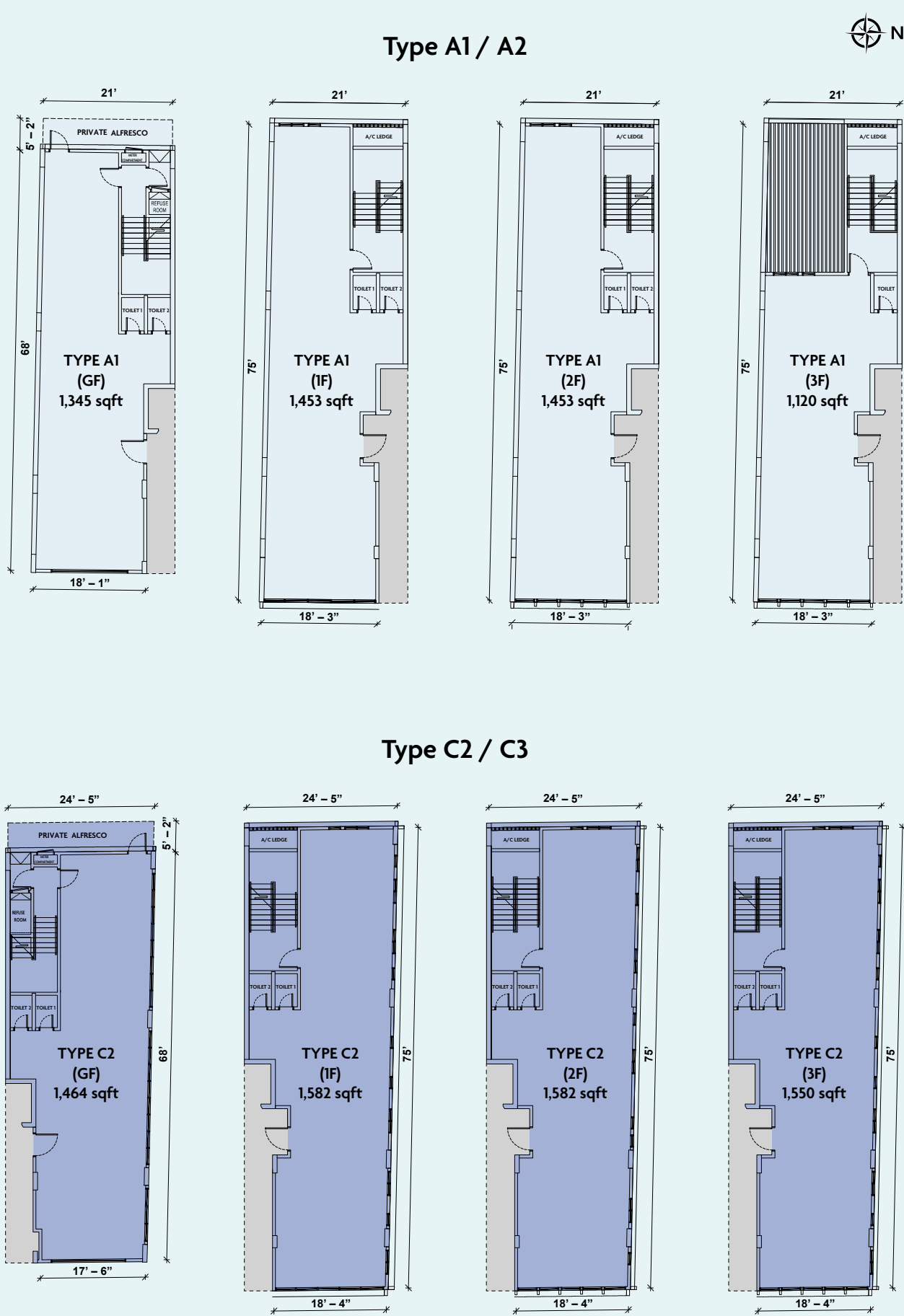



ANCUBIC  
HARMONI CITY



Surrounded By Matured Townships With Excellent Highways In An Upcoming Value-Added City

Ready catchment

Close to KLIA & Government Administrative Centre, Putrajaya

Nearby schools & universities

300 retail shops surrounding Botanical Park

Home to largest high-end grocer

500 retail shops within surrounding townships

24-hour security

Professional property management company to manage AirBnB units

110 EV charging car parks

Ancubic Lifestyle Pickleball Club\* & Sports Complex  
\*Subject to operator's lease period

1.5km circular pet-friendly Botanical Park walkpath

Upcoming wellness centre

Botanical Alley walkway with kiosks

Ideal Space For Businesses:

- Aesthetic clinic
  - Antique shop
  - Artisanal bakery
  - Arts & craft centre
  - Audiophile shop
  - Auto detailing shop
- Beauty or hair salons
  - Bespoke tailor
  - Bespoke watch gallery
  - Bicycle fitting specialist
  - Bookstore
  - Boutique
- Children enrichment centre
  - Convenience store
  - Co-working space
  - Culinary school
  - Dance studio
  - Day spa
- Eco-friendly household supplies
  - Fine dining, specialty restaurants
  - E-Sports Club
  - Fitness equipment showroom
- Fitness studios
  - Florist & gift shop
  - Handmade craft
  - Hobby centre
  - Home improvement
  - Kid's play centre
- Language learning centre
  - Kitchen ware centre
  - Solicitors
  - Luxury furniture & home décor
  - Martial arts school
  - Medical diagnostic centre
- Mobile phones shop
  - Music school
  - Optical shop
  - Organic supplies
  - Outdoor gear & camping
  - Pet café & themed café
- Pet grooming or pet shops
  - Pharmacy
  - Physiotherapy
  - Scuba diving shop
  - Smart home solutions centre
- Specialty dessert shop
  - Specialty tea house
  - Sports accessories
  - Tech & gadget shop
  - Tuition centre & many more